

Wellen W

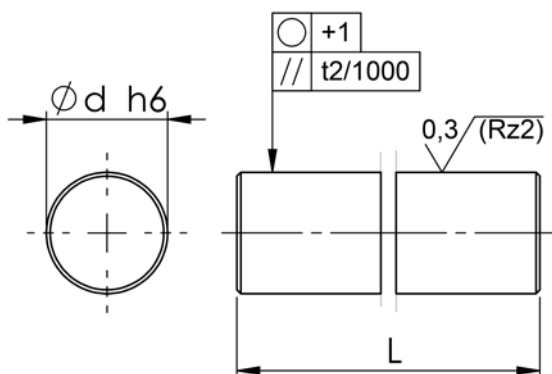

nach DIN ISO 13012



Teile-Nr.	Abmessungen in mm			
	Material: Cf53 (1.1213) HRC62 ±2			geschliffen
W	d	L max.	Gewicht kg/m	ISO Toleranz h6 / μm
W 5	5	3900	0,154	0 -8
W 6	6	6000	0,222	0 -9
W 8	8	6000	0,395	0 -9
W 10	10	6000	0,617	0 -11
W 12	12	6000	0,888	0 -11
W 14	14	6000	1,208	0 -11
W 15	15	6000	1,387	0 -11
W 16	16	6000	1,578	0 -11
W 18	18	6000	1,998	0 -13
W 20	20	6000	2,466	0 -13
W 22	22	6000	2,984	0 -13
W 24	24	6000	3,551	0 -13
W 25	25	6000	3,853	0 -13
W 30	30	6000	5,549	0 -16
W 32	32	6000	6,313	0 -16
W 35	35	6000	7,553	0 -16
W 36	36	6000	7,990	0 -16
W 40	40	6000	9,865	0 -19
W 45	45	6000	12,480	0 -19
W 50	50	6000	15,410	0 -19
W 60	60	6000	22,200	0 -19
W 70	70	6000	30,210	0 -19
W 80	80	6000	39,460	0 -19
W100	100	6000	61,650	0 -22

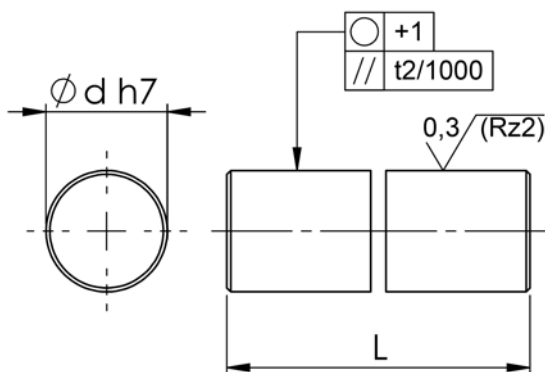

Teile-Nr.	Abmessungen in mm			
	Material: Cf53 (1.1213) HRC62 ±2			verchromt
W	d	L max.	Gewicht kg/m	ISO Toleranz h7 / μm
W 5	5	2000	0,154	0 -12
W 6	6	3900	0,222	0 -15
W 8	8	3900	0,395	0 -15
W 10	10	6000	0,617	0 -18
W 12	12	6000	0,888	0 -18
W 14	14	6000	1,208	0 -18
W 15	15	6000	1,387	0 -18
W 16	16	6000	1,578	0 -18
W 20	20	6000	2,466	0 -21
W 24	24	6000	3,551	0 -21
W 25	25	6000	3,853	0 -21
W 30	30	6000	5,549	0 -21
W 32	32	6000	6,313	0 -13
W 35	35	6000	7,553	0 -16
W 40	40	6000	9,865	0 -16
W 50	50	6000	15,410	0 -16
W 60	60	6000	22,200	0 -16
W 80	80	6000	39,460	0 -19